



THE DAY TRIPPERS CATALOGUE

Perfect for overnight adventures for couples

SUMMER 2020

SUPERYACHTS ARE COMING TO SAUDI ARABIA
FOR YOUR POST LOCK-DOWN STAYCATION!
DEPARTING JEDDAH FROM 10 JULY

INTRODUCING RED SEA ESCAPES



Finally the lockdown has been lifted! And while international travel will be limited this summer, Escapes are bringing incredible experiences into Saudi Arabia with a brand-new concept -the Red Sea Escapes.

For the first time ever, from 10 July Saudi Arabia's favourite luxury travel company has been authorised to bring a handpicked selection of yachts into the crystal blue waters of the Saudi Red Sea, for your pleasure. This means the chance for that family summer holiday is not lost!

The perfect opportunity to reconnect with friends and family, charter one of our boats and enjoy some time out on the water. Spend your days cruising the stunning uncharted Red Sea and surrounds, soaking up the sunshine, having fun with the latest marine activities and feasting on five-star catering from our renowned chefs.



NATASHA

**10 000\$
PER DAY**

NATASHA

Length: 17.6 m meters (58')

Width: 5 m meters (16' 4')

Number of Guests: 6

Number of Crew: 2

Built: 2009

Builder: Sunseeker predator 52

Naval Architect: Builder

Flag: Delaware

Hull Construction: Sunseeker

Hull Configuration: Fiberglass

The optimal length of the yacht Sunseeker Predator 52 combines great speed and quality of a particular, recognizable style. The streamlined design hides the internal helm console with a rounded, high-performance control and monitoring of all important processes. There is also a spacious and functional interior, while on the lower deck - well-equipped galley. The automatically lifting swimming platform is offered for relaxation. The yacht is hardly exploited and in perfect condition,

KEY FEATURES

1 Spacious and functional interior

2 3 Cabins – options of double and twin beds

3 Slick and modern interior and exterior

4 Air Conditioned

5 Beautiful furnishings and relaxed seating area

7 Leisure and entertainment facilities



Profile



Sundeck Sitting Area



Features/ Sundeck Sunbeds



Front



Sitting Areas



Deck

SPECIFICATIONS

ACCOMMODATION

Number of Guests: 6 - 12

Number of Cabins: 3

Cabin Configuration: Double & Twin

Bed Configuration: 2 x Queen & 1 x Twin

EQUIPMENT

Engines:

- Main engines: Volvo D12-800
- Main generators: MTU
- Fuel capacity: 2140 Liters
- Potable water: 625 Litres
- **Cruising Speed:** 28 Knots

LAYOUT

Top view

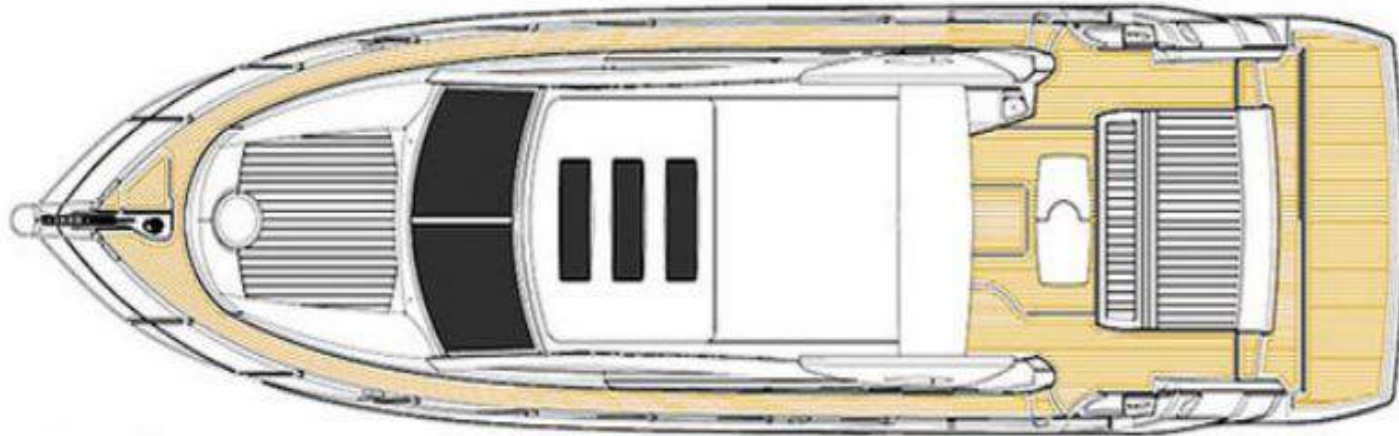

LAYOUT

Main deck

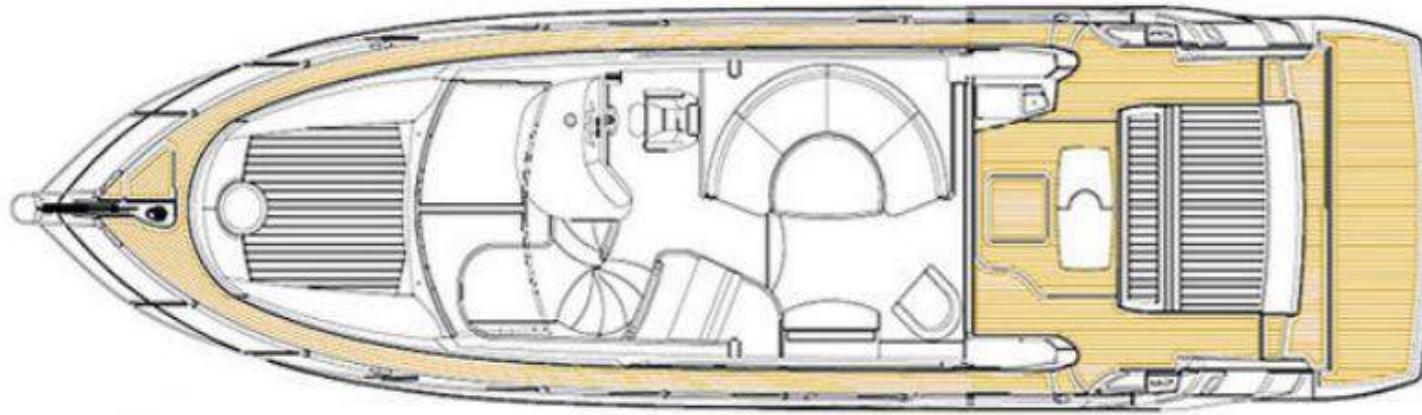

LAYOUT

Lower deck

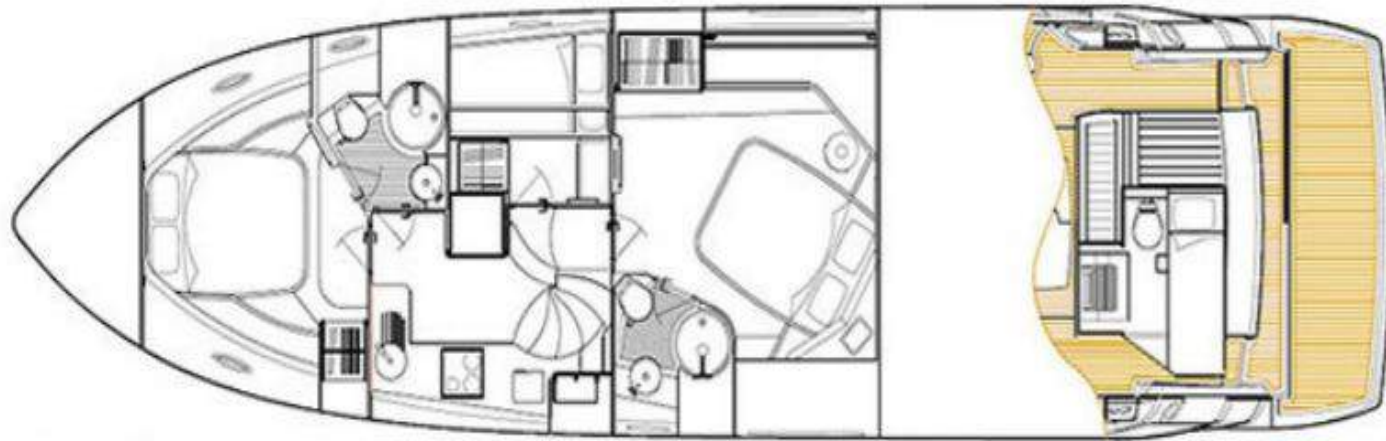

**10 000\$
PER DAY**

SAMURAI



SAMURAI

Length: 20 metres (68')

Width: 5 metres (16')

Number of Guests: 6

Number of Cabins: 3

Number of Crew: 2

Built: 2010

Builder: Aicon Yacht

Flag: Delaware

Hull Construction: Accion

Hull Configuration: Fiberglass

Fast boat, very stable and very comfortable with the opportunity to dine inside and outside in full comfort.

Large back deck with convertible dining table that can open to a large saloon.

All cabins contains tv with DVD and Sony radio cd sound systems.

The boat offers great space for her size and guests will be able to relax either on the aft deck (the dining can be converted into a sunbathing area) or on the foredeck. If you're looking for a family yacht charter or a yachting vacation with your friends, look no further! Charter guests will have the best yachting holiday onboard this Aicon 62SL.

KEY FEATURES

- 1** Rare and stylish motor yacht. A large amount of space below deck in the cabins, bathrooms, kitchen and living room, the ability to separate from the rest of the crew.
- 2** Professionally maintained and very lightly used. Expansive 2 covered areas, 1 saloon and 1 kitchen area.
- 3** Advanced music system, Bose lifestyle.
- 4** Hot Tub with opening sky roof.
- 5** Sony radio cd sound systems in saloon and all cabins; Sony radio cd system deck.
- 6** Salon creme leather upholstery in salon; Samsung tv with DVD player and satellite receiver in salon.



Sundeck Sitting Area



Master Cabin



Deck



Deck



Cabin



Saloon



Sitting Areas



Kitchenette



Kitchenette



Cabin



Cabin



Tender



Exterior

SPECIFICATIONS

ACCOMMODATION

Number of Guests: 6

Number of Cabins: 3

Bed Configuration: 2 Queen bed, 1 single beds

EQUIPMENT

Engines:

- Main engines: MAN 1250 Hp X 2
- Fuel capacity: 800 Litres
- Potable water: 180 Litres
- **Cruising Speed:** Cruising 22 knots; maximum 36 knots

WATERSPORTS

Tenders + Toys:

TENDERS:

- Williams 325 jet 120 hp

TOYS:

Mixed water toys

LAYOUT

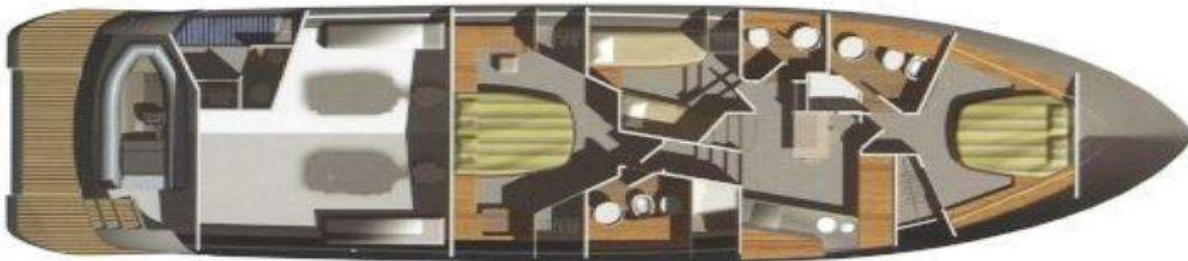

LAYOUT

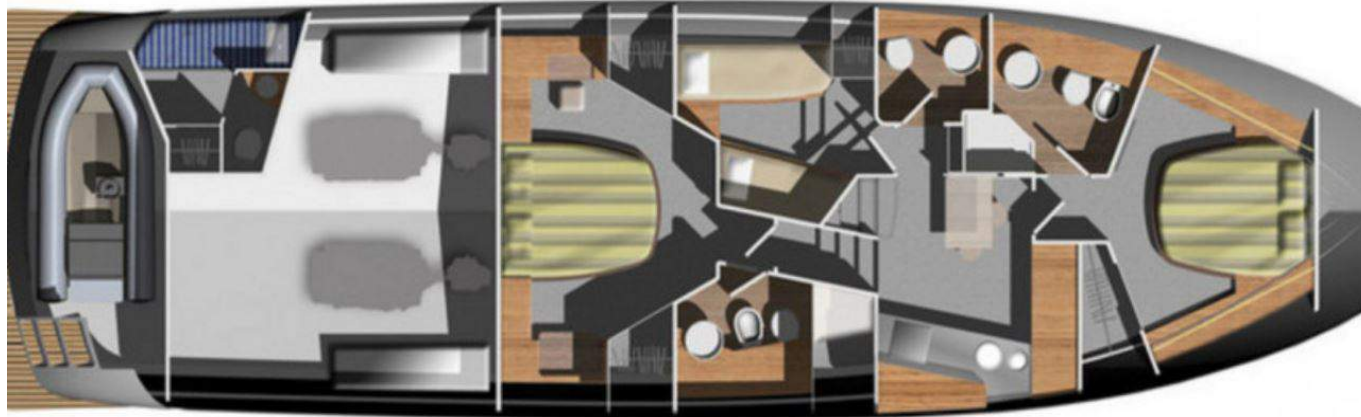

ABOUT ESCAPES



At Escapes we know the world in a way that can set you on a different path, which is handpicked, just for you. We're setting a new benchmark in luxury travel, and we invite you to join us on the road less travelled, where destinations are discovered, not visited; where the world is your playground and quality is never up for compromise. For our discerning travellers, being an Escapes client means a close relationship with their dedicated travel expert, who they can trust to provide them with the best service and unparalleled travel experiences, with their every need anticipated and their every whim indulged.

ESCAPES SERVICES



Bespoke Trips | Immersive Experiences | Private Yacht Chartering | Private Aviation and Helicopter | Luxury Worldwide Villas | Wellness | Medical | VIP Airport Services | Luxury Transportation | Butlers and Personal Shoppers | Concierge Services | On-Ground Escapes Coordinator

READY TO BOOK YOUR RED SEA ESCAPE?



HIGH DEMAND is expected, so reserve your yacht charter TODAY!

Reach out to us now for more information on the yacht category of your choice.

CHARTERS ARE RUNNING FROM 10 JULY – 15 AUGUST 2020

CONTACT

+971 (0) 4 425 8434
escapestravel.com
redsea@escapestravel.com

DUBAI

Office 407,
Platinum
Tower, Cluster I, JLT

RIYADH

R House, Office
34• Tafaseel
Center, Building A

We look forward to welcoming you aboard!